

# Frontliner

## Fx2

The Fx2 is a tool that truly lives up to its name: Frontliner. The lightness and the ability to both spread, cut and pull; it is the tool for first line attack. The Fx2 is so compact, and easy to handle it gives you the ability to get into places a bigger cutter cannot and change positions fast! It does not have the capacity of the Fx4 and 6, but it is the highest performer in its class and will be able to perform most of the tasks you come across. Departments buy it for the first intervention, and then bring in the bigger tools if the situation asks for it. Designed with EWOTECHNOLOGY you truly have the lightest, performance combination tool on the market.

### Features:

- UltimatePressure
- EWOTECHNOLOGY
- Detachable jaws

### Facts:

- Best power to weight ratio
- Lightest rapid intervention tool in its class
- Most powerful light-duty combination tool
- Highest safety factors on critical parts



PRESSURE™  
ULTIMATE

Fx2 Frontliner: do not judge it on his weight...

**Advanced blade design:** gives you control over the cutting action from round bar to long structures

**Detachable jaws:** to easily make it into a full capacity dedicated cutter

**Fixed 360° handle:** enables the user to have balance in every position and change positions quickly

**Flat bolt design:** lowers the insertion height of the tool, enabling you to reach confined spaces

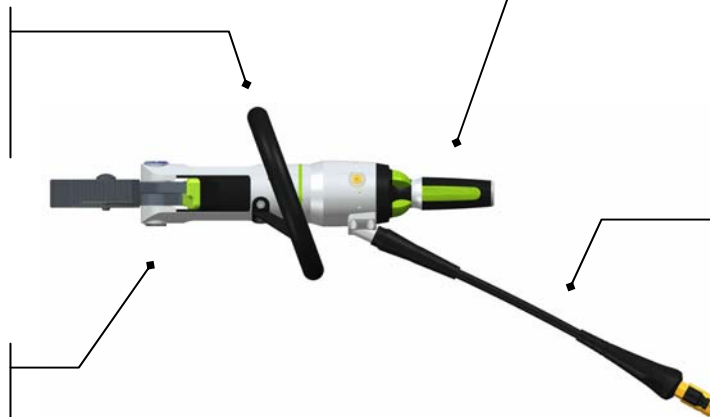

**Real protective covering:** for all dangerous turning parts

**Quick connectors:** easy and fast to connect. Automatic locking and flat-face design prevent sand and dirt from getting in the couplers. A rescuers' favorite

**Duo control:** handle for both thumb and/or twist control in one. Ergonomically designed for best control in every position. No risk to the user as no hydraulics go through the handle.

**360° turning tail-hoses:** so they never interfere with operation and don't take up space when stored. Withstand 8x the working pressure, making them the safest available

FRONTLINER Fx-series

## Technical specifications Fx2

Model	Fx2 Frontliner
Nominal pressure	UltimatePSI™ / 5000 PSI / 350 Bar
Dimensions (LxWxH)	26 3/4" x 8 13/16" x 9 11/16" // 679 x 224 x 246 mm
Operational weight	24,5 lb / 11,1 kg
Max. cutting opening	7 11/16" / 195 mm
Max. cutting force	76,409 lbs / 38.2 US tons / 340 kN / 34.7 ton
Max.spreading opening	10 11/16" / 271 mm
Max.spreading force	21,282 lbs / 10.6 US tons / 94.7 kN / 9.7 ton
Max.pulling opening	13 1/6" / 331 mm
Max.pulling force	3.7 US tons / 32.7 kN / 3.3 ton
EN 13204	Compliant
NFPA 1936	Compliant

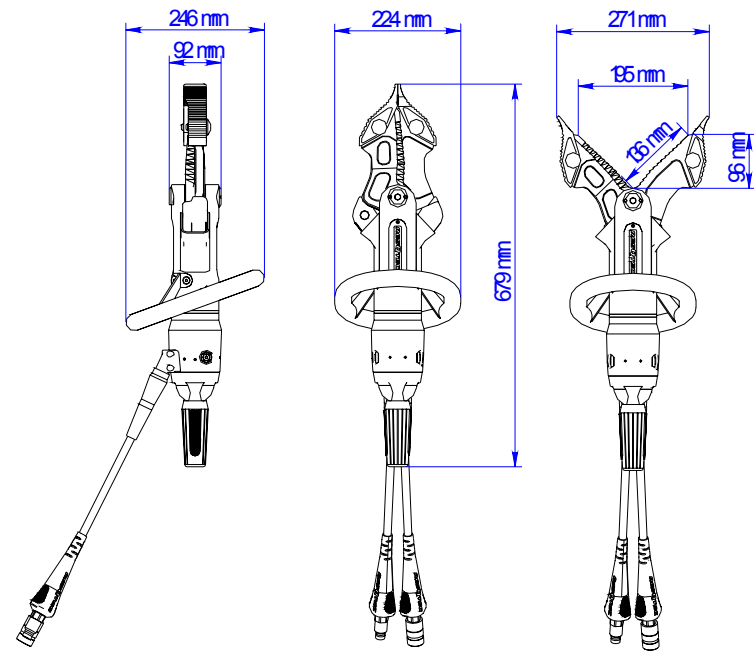

**RESQTEC®**

RESQTEC® is a registered trademark

© RESQTEC® 2005  
Technical modifications reserved

RESQTEC Zumro b.v.  
Meer en Duin 82  
2163 HC, Lisse  
the Netherlands

T: +31 (0)252 419002  
F: +31 (0)252 411794  
E: info@resqtec.com  
I: www.resqtec.com

RESQTEC, Inc.  
3333 Foerster Road  
St. Louis, MO 63044  
USA

T: (314) 439 2890  
F: (314) 439 2895